



mobility**community**

murchisonroad | corridorstudy | phaseII

december**2008**

Prepared For:
City of
Fayetteville, NC



In Conjunction With:
North Carolina
Department of
Transportation &
Fayetteville Area MPO



Prepared By:
Kimley-Horn and
Associates, Inc.

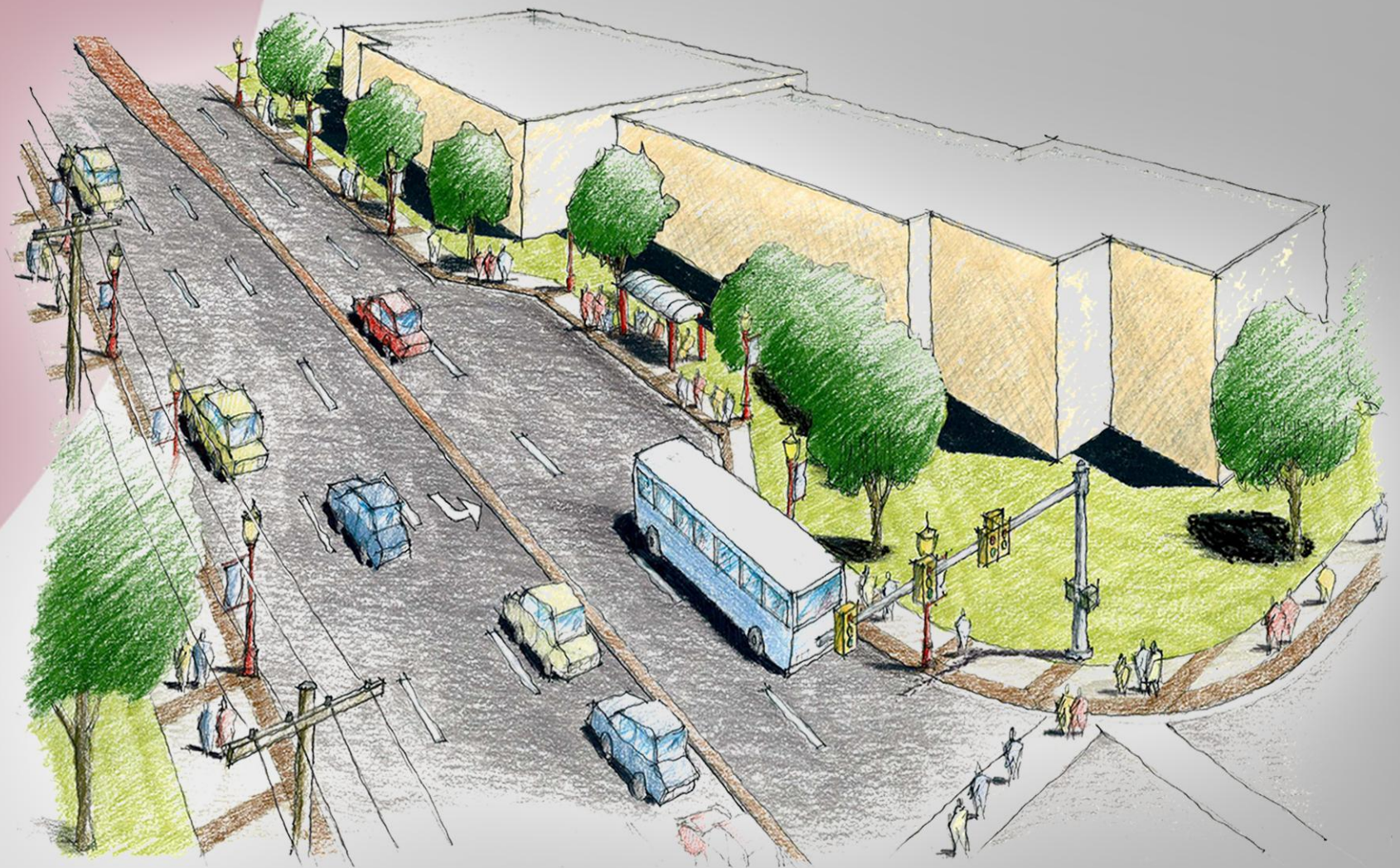



TABLE OF CONTENTS

1 | PLANNING PROCESS & CONTEXT

- BACKGROUND & HISTORY 1-1
 - Phase I 1-2
 - Market Analysis 1-2
 - Committed Projects 1-3
- NEED FOR PROJECT 1-4
- STUDY AREA 1-4
- PLANNING PROCESS 1-6
 - Existing Conditions Inventory 1-6
 - Phase II Public Design Charrette 1-6
 - Advisory Committee 1-7
 - Stakeholder Interviews 1-7
 - Design Alternatives 1-7
 - Public / Council Presentation 1-7
- THE CHARRETTE 1-8
 - Day 1: Who & Why? 1-8
 - Days 2 & 3: What & Where? 1-9
 - Day 4: How & When? 1-10

2 | MURCHISON – “TODAY & TOMORROW”

- CORRIDOR CONTEXT & LAND USE 2-1
 - Murchison’s Context Zones 2-1
 - Related Projects 2-3
 - Phase I Catalyst Projects 2-3
- ENVIRONMENTAL 2-4
- COMMUNITY & DEMOGRAPHICS 2-5
- TRANSPORTATION 2-14
 - Traffic Today 2-14
 - Safety 2-15
 - Bicycle & Pedestrian 2-15
 - Transit 2-15

3 | FINDINGS & RECOMMENDATIONS

- SYSTEM IMPROVEMENTS 3-1
 - Regional Connectivity 3-1

- Greenway Connectivity 3-3
- FUTURE TRAFFIC 3-3
- CORRIDOR IMPROVEMENTS 3-5
 - I-295 to Pamalee Drive 3-5
 - Pamalee Drive to Langdon Street 3-8
 - Langdon Street to MLK Freeway 3-10
- CATALYST PROJECTS 3-15
 - Proposed Development 3-15
 - Pamalee Crossroads 3-15
 - Washington Drive/High School 3-16
- BRANDING 3-17

4 | INVITING SUCCESS

- ACTION PLAN 4-1
- CONSTRUCTION PHASING 4-2
- POLICY MEASURES 4-3
- FUNDING OPPORTUNITIES 4-4
 - Local Programs 4-5
 - State & Federal Programs 4-5
 - Public/Private Initiatives 4-6

5 | CONCLUSIONS

- MURCHISON ROAD IMPROVEMENTS 5-1
 - I-295 to Pamalee Drive 5-1
 - Country Club Drive/Pamalee Drive Intersection 5-1
 - Pamalee Drive to Langdon Street 5-1
 - Langdon Street to MLK Freeway 5-2
- SYSTEMWIDE IMPROVEMENTS 5-3
 - Connectivity 5-3
 - Greenways 5-3
 - Branding & Wayfinding 5-4
- CATALYST PROJECTS 5-4
- FUNDING & IMPLEMENTATION 5-5

CONCEPTUAL DESIGN MAPS APPENDIX

ACKNOWLEDGEMENTS

Murchison Road Corridor Task Force

Rusty Thompson, Project Manager
City of Fayetteville

Robert Botley
Fayetteville State University

Julian Brown
Community Representative

Rudy Cardenas
Fayetteville State University

Chris Harris
Community Representative

Rick Heicksen
Fayetteville Area MPO

Melvin Henderson
Community Representative

Karen Hilton
City of Fayetteville

Lee Jernigan
NCDOT Division 6

Tripp Jones
Community Representative

Ron Mancuso
Fayetteville Area System of Transportation

Harold Miller
Fayetteville State University

Kyle Sonnenberg
City of Fayetteville

Jimmy Teal
City of Fayetteville



TABLE OF CONTENTS

LIST OF FIGURES

FIGURE 1. MURCHISON ROAD STUDY AREA1-4

FIGURE 2. MURCHISON’S CONTEXT ZONES.....2-2

FIGURE 3. NATURAL, ENVIRONMENTAL, AND CULTURAL FEATURES.....2-6

FIGURE 4. DEMOGRAPHICS – PERCENT MINORITY2-8

FIGURE 5. DEMOGRAPHICS – PERCENT HISPANIC2-10

FIGURE 6. DEMOGRAPHICS – PERCENT BELOW POVERTY LINE.....2-12

FIGURE 7. TRANSPORTATION ELEMENTS2-16

FIGURE 8. INTERSECTION CRASH DATA, 2005-20072-18

FIGURE 9. CONNECTIVITY RECOMMENDATIONS.....3-2

FIGURE 10. MURCHISON/COUNTRY CLUB/PAMALEE QUADRANT INTERSECTION CONCEPT3-7

FIGURE 11. FAYETTEVILLE STATE STREETScape CONCEPT3-12

FIGURE 12. WAYFINDING RECOMMENDATIONS.....3-20

LIST OF TABLES

TABLE 1. PHASE I ECONOMIC FORECAST 1-3

TABLE 2. TIP PROJECTS PLANNED IN THE VICINITY OF THE STUDY AREA..... 1-3

TABLE 3. AVERAGE DAILY TRAFFIC VOLUMES (2005)..... 2-14

TABLE 4. INTERSECTION LEVEL-OF-SERVICE CONTROL DELAY THRESHOLDS 2-14

TABLE 5. INTERSECTION LEVEL-OF-SERVICE SUMMARY (EXISTING) 2-15

TABLE 6. TOP TEN CRASH INTERSECTIONS (2005-2007)..... 2-18

TABLE 7. TRAFFIC GROWTH AND OPERATIONS, 2005-2020 3-3

TABLE 8. LEVEL-OF-SERVICE SUMMARY (NO BUILD) 3-4

TABLE 9. LEVEL-OF-SERVICE SUMMARY (2020) I-295 TO PAMALEE DRIVE 3-5

TABLE 10. LEVEL-OF-SERVICE SUMMARY (2020) PAMALEE DRIVE TO LANGDON STREET 3-8

TABLE 11. LEVEL-OF-SERVICE SUMMARY (2020) LANGDON STREET TO MLK EXPRESSWAY 3-10

ACKNOWLEDGEMENTS

Fayetteville City Council

Anthony G. Chavonne, Mayor
 Wesley A. Meredith, Mayor Pro Tempore
 Valencia Applewhite
 Keith A. Bates, Sr.
 Bill Crisp
 Charles Evans
 Darrell "DJ" Haire
 Bobby Hurst
 Robert A. Massey, Jr.
 Ted Mohn

Kimley-Horn Project Team

Mike Rutkowski
 Todd Delk
 Larry Meisner
 Matt West
 Stephanie Privette
 Mark Dunzo
 Julie Gavin
 Matt Noonkester
 Lauren Pletner
 Ben Taylor
 Jonathan Whitehurst
 Brett Wood
 Roger Henderson
 Mitch Danforth

LandDesign

Meg Nealon
 Scott Lageaux

Neighboring Concepts

James Williams
 Brian Keech
 Eric Orozco

John Davenport Engineering, Inc.
 John Davenport