



## Pavement Preservation Program

Various Resurfacing Streets for Bond Budget (\$6 M:Phase 1):

Street Name	PCI	From Street	To Street	Width (ft)	Length (ft)
Vista Dr	66	Branson St	Cul-De-Sac	35	2678
Morgan St	68	Bryan St	Broadfoot Ave	26	695
Mcrae Dr	62	McBain Dr	McBain Dr	34	938
Alexander St	65	S Cool Springs St	E Russell St	33	1554
Barkley Dr	68	Huntington Rd	Bennington Rd	33	420
Wayberry Dr	58	Millbrook Rd	Mirror Lake Dr	33	870
White Oak Ct	68	Huntington Rd	Cul-De-Sac	33	511
John St	69	Morganton Rd	Rush Rd	22	1230
Ruth St	65	Morganton Rd	Rush Rd	22	1130
Judd St	58	Morganton Rd	Dead End	22	1160
S Racepath Dr	35	Dead End	Cul-De-Sac	28	1450
Rolling Hill Rd	53	Colgate Dr	Dead End	29	5271
Filter Plant Dr	34	Bragg Blvd	Murchison Rd	33	2695
Malloy St	55	Judd St	Sedberry St	21	270
Sedberry St	64	Malloy St	Dead End	23	750
Lamb St	55	Morganton Rd	Dead End	33	832
Sunnyside Cir	56	Lamb St	Cul-De-Sac	33	148
Overlook Dr	48	Scott Ave	Stuart Ave	32	1010
Roxie Ave	77	Raeford Rd	Boone Trail	30	9190
Desmond Dr	76	Balloon Dr	Cul-De-Sac	26	416
Waters Edge Dr	63	Cliffdale Rd	Dead End	33	5960
Skycrest Dr	58	Marlborough Rd	Hermitage Ave	33	2902

Street Name	PCI	From Street	To Street	Width (ft)	Length (ft)
Notre Dame Pl	45	Dartmouth Dr	Fordham Dr	32	490
Manos St	58	Mullis St	Mike St	20	756
Sinclair St	47	Bancroft Dr	Dead End	22	453
Mullins Ave	45	Buckingham Ave	Ramsey St	33	726
Gilmore St	59	Brookwood Ave	Dead End	33	664
Fletcher Ave	46	Brewster Dr	Dead End	25	793
Boros Dr	68	Entire Street		25	4627
Barber Ave	49	Boros Dr	Maxine St	25	930
Grampian Ct	42.2	Paisley Ave	Cul-De-Sac	24	375
Mountain Ash Ln	47	Tokay Dr	Glenola St	27	525
Montrose Dr	41	Loxley Dr	Cul-De-Sac	26	514
Barfield Dr	80	Adrian Dr	Heathcote (Joint)	26	141
Uriah Dr	65	Adrian Dr	Clairborne Dr	26	564
Rivendale Dr	53	Hazelhurst Dr	Dot Joint	37	81
Blanton Rd	62	Johnson St	Pamalee Dr	25	3940
Edenwood Dr	67	Anarine Rd	Lyon Rd	33	1309
Rustland Dr	64	Cul-De-Sac	Dead End	24	1670
Oakview Dr	63	Kodiak Dr	Coleridge Dr	26	1344
Norberry Ct	56	Coleridge Dr	Cul-De-Sac	27	379
Glenbrook Dr	50	Beaver Run Dr	Flintwood Rd	26	582
Blackbird Rd	48	Elkhorn Dr	Southbend Dr	27	1067
Buhmann Dr	39	Southbend Dr	Cliffdale Rd	24	3491
Green Valley Rd	65	Country Club Dr	Dead End	28	3150
Sparrow Dr	43	Beaver Run Dr	Pebblebrook Dr	26	280
Battle Rd	55	Beaver Run Dr	Pin Oak Ln	26	626
Whisker Lake Dr	61	Dead End	Cul-De-Sac	25	1154
Ludin Ln	58	Whisker Lake Dr	Dead End	25	253
Turkey Run	56	Whisker Lake Dr	Cul-De-Sac	26	334

Street Name	PCI	From Street	To Street	Width (ft)	Length (ft)
Tolgate Rd	59	Old Field Rd	Bent Pine Dr	24	1631
Hodhat Dr	42	Hoke Loop Rd	Dead End	34	632
Greenock Ave	54	Paisley Ave	Mcdougal Dr	23	3214
East Loch Haven Dr	47	Morganton Rd	Conifer Dr	29	3653
Abbottswood Dr	32	Copenhagen Dr	Broadview Dr	26	2279
Copenhagen Dr	66	Eastwood Ave	Cul-De-Sac	26	1308
Baltosrol Ln	56	Abbottswood Dr	Dead End	25	102
Merrieffield Ct	69	Abbottswood Dr	Cul-De-Sac	25	81
Briarcreek Pl	59	Dartmouth Dr	Cul-De-Sac	26	1323
Sudbury Dr	48	Applewhite Rd	Dead End	27	1913
Apsley Ct	41	Applewhite Rd	Cul-De-Sac	27	830
Foxton Ct	42	Vaughn Rd	Cul-De-Sac	26	535
Vaughn Rd	47	Sudbury Dr	Apsley Ct	27	1132
<b>Total Length: 91,931 ft or 17.41 Miles</b>					



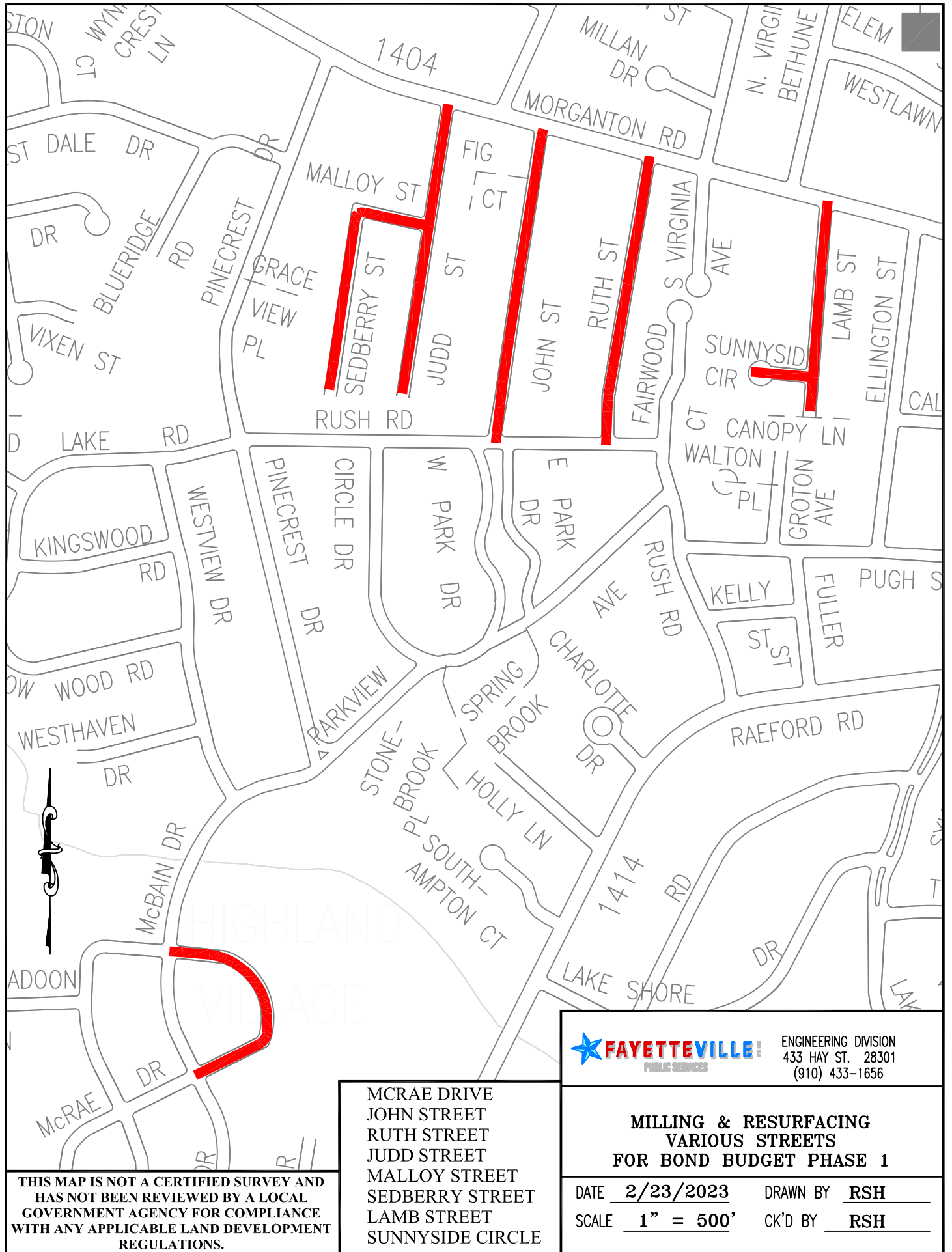

THIS MAP IS NOT A CERTIFIED SURVEY AND HAS NOT BEEN REVIEWED BY A LOCAL GOVERNMENT AGENCY FOR COMPLIANCE WITH ANY APPLICABLE LAND DEVELOPMENT REGULATIONS.

MCRAE DRIVE  
 JOHN STREET  
 RUTH STREET  
 JUDD STREET  
 MALLOY STREET  
 SEDBERRY STREET  
 LAMB STREET  
 SUNNYSIDE CIRCLE

**FAYETTEVILLE** ENGINEERING DIVISION  
PUBLIC SERVICES 433 HAY ST. 28301  
 (910) 433-1656

**MILLING & RESURFACING  
 VARIOUS STREETS  
 FOR BOND BUDGET PHASE 1**

DATE 2/23/2023 DRAWN BY RSH  
 SCALE 1" = 500' CK'D BY RSH

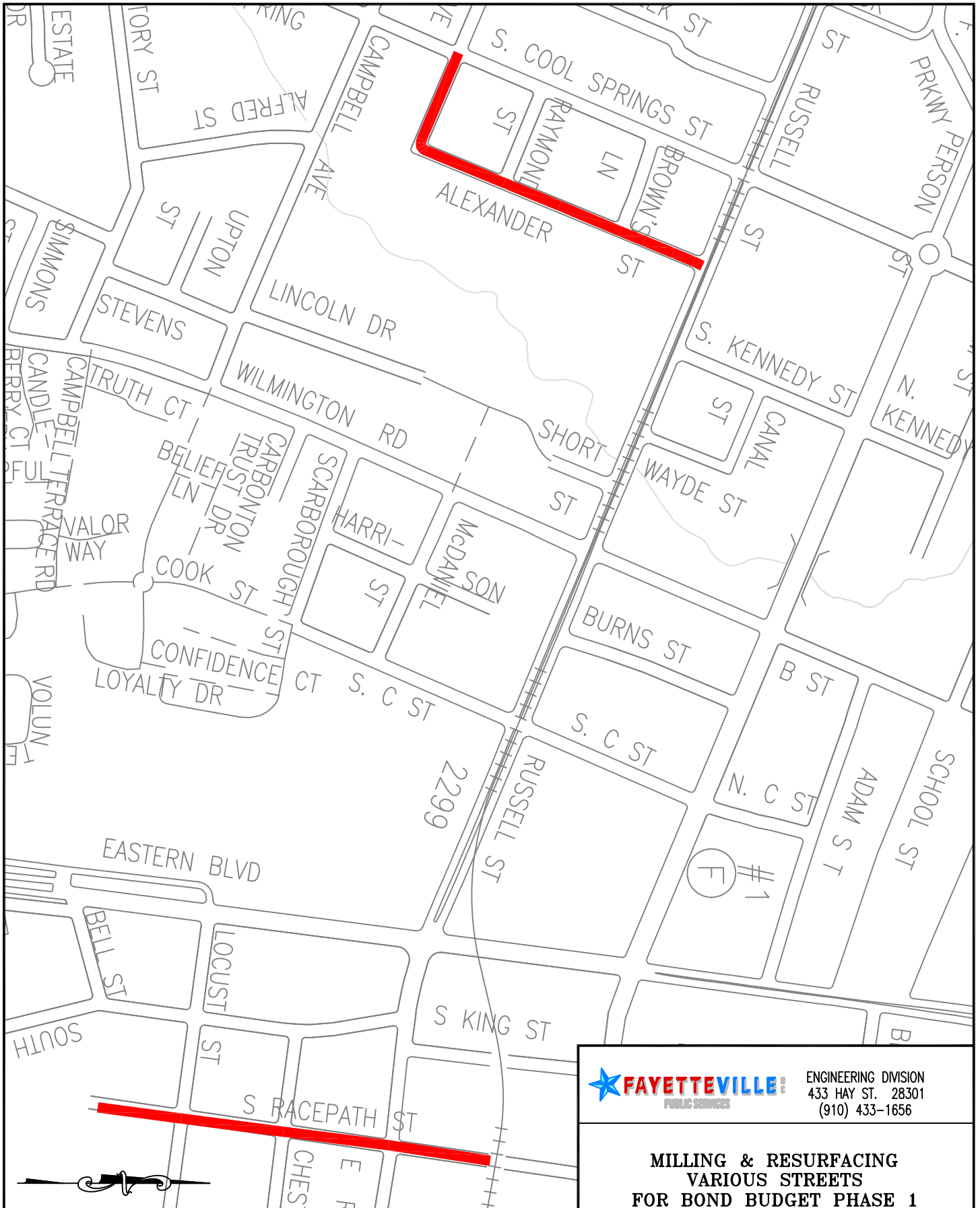

ENGINEERING DIVISION  
 433 HAY ST. 28301  
 (910) 433-1656

**MILLING & RESURFACING  
 VARIOUS STREETS  
 FOR BOND BUDGET PHASE 1**

DATE 2/23/2023 DRAWN BY RSH  
 SCALE 1" = 500' CK'D BY RSH

ALEXANDER STREET  
 S RACEPATH DRIVE

**THIS MAP IS NOT A CERTIFIED SURVEY AND  
 HAS NOT BEEN REVIEWED BY A LOCAL  
 GOVERNMENT AGENCY FOR COMPLIANCE  
 WITH ANY APPLICABLE LAND DEVELOPMENT  
 REGULATIONS.**



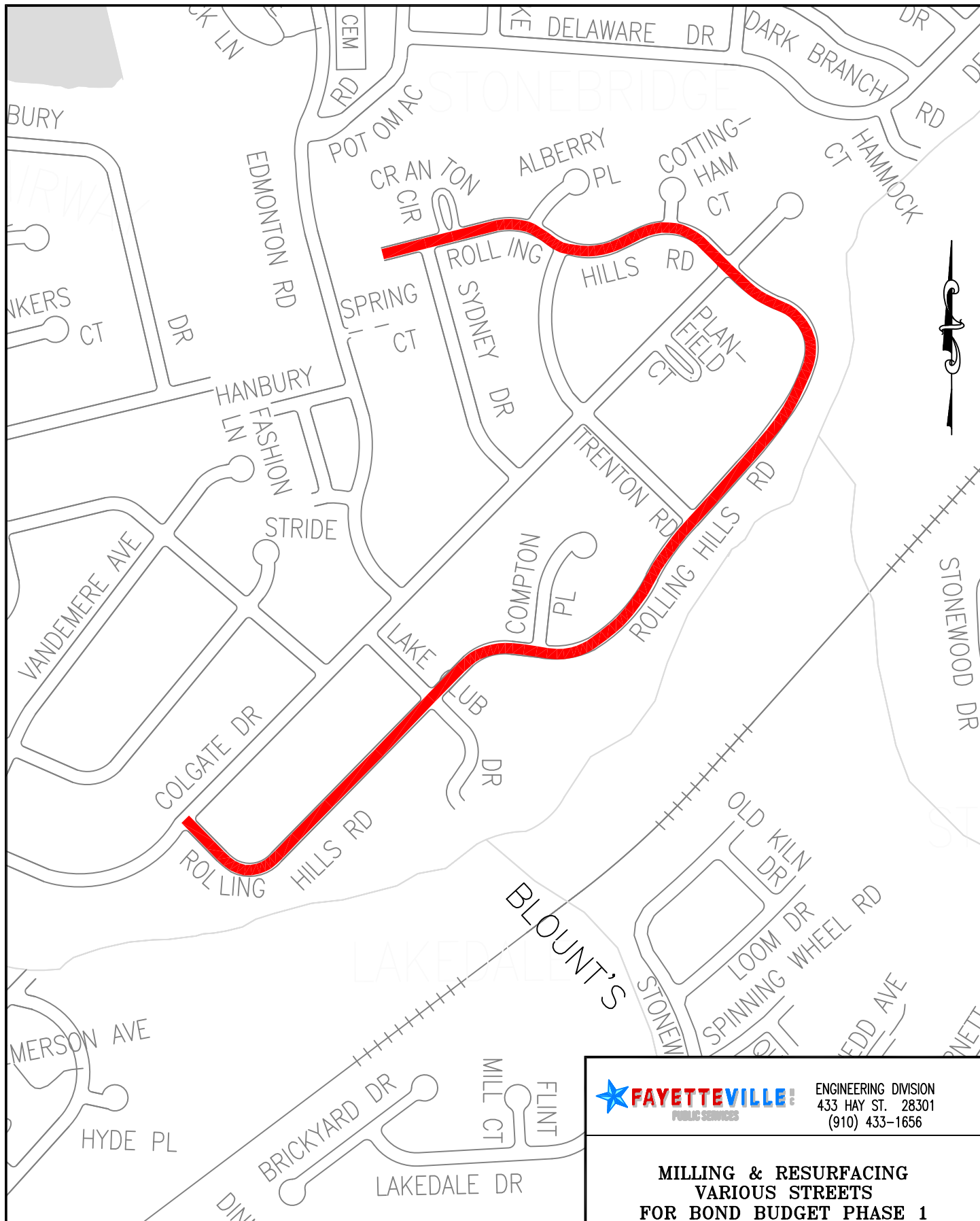

**FAYETTEVILLE** ENGINEERING DIVISION  
PUBLIC SERVICES 433 HAY ST. 28301  
 (910) 433-1656

**MILLING & RESURFACING  
 VARIOUS STREETS  
 FOR BOND BUDGET PHASE 1**

ROLLING HILL  
 ROAD

THIS MAP IS NOT A CERTIFIED SURVEY AND  
 HAS NOT BEEN REVIEWED BY A LOCAL  
 GOVERNMENT AGENCY FOR COMPLIANCE  
 WITH ANY APPLICABLE LAND DEVELOPMENT  
 REGULATIONS.

DATE 2/23/2023 DRAWN BY RSH  
 SCALE 1" = 500' CK'D BY RSH



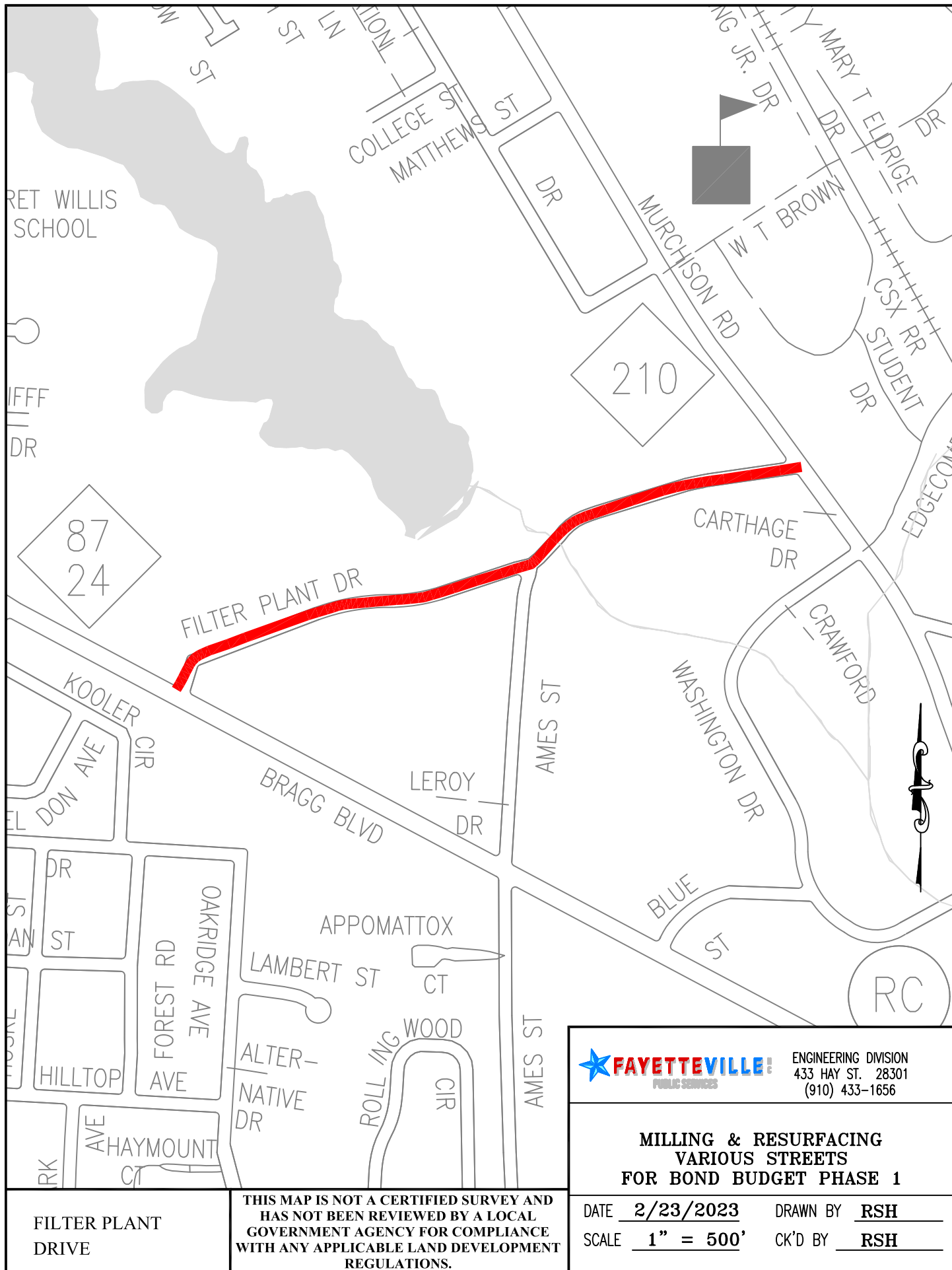

FILTER PLANT  
DRIVE

**THIS MAP IS NOT A CERTIFIED SURVEY AND  
HAS NOT BEEN REVIEWED BY A LOCAL  
GOVERNMENT AGENCY FOR COMPLIANCE  
WITH ANY APPLICABLE LAND DEVELOPMENT  
REGULATIONS.**

**FAYETTEVILLE** ENGINEERING DIVISION  
PUBLIC SERVICES 433 HAY ST. 28301  
(910) 433-1656

**MILLING & RESURFACING  
VARIOUS STREETS  
FOR BOND BUDGET PHASE 1**

DATE 2/23/2023 DRAWN BY RSH  
SCALE 1" = 500' CK'D BY RSH

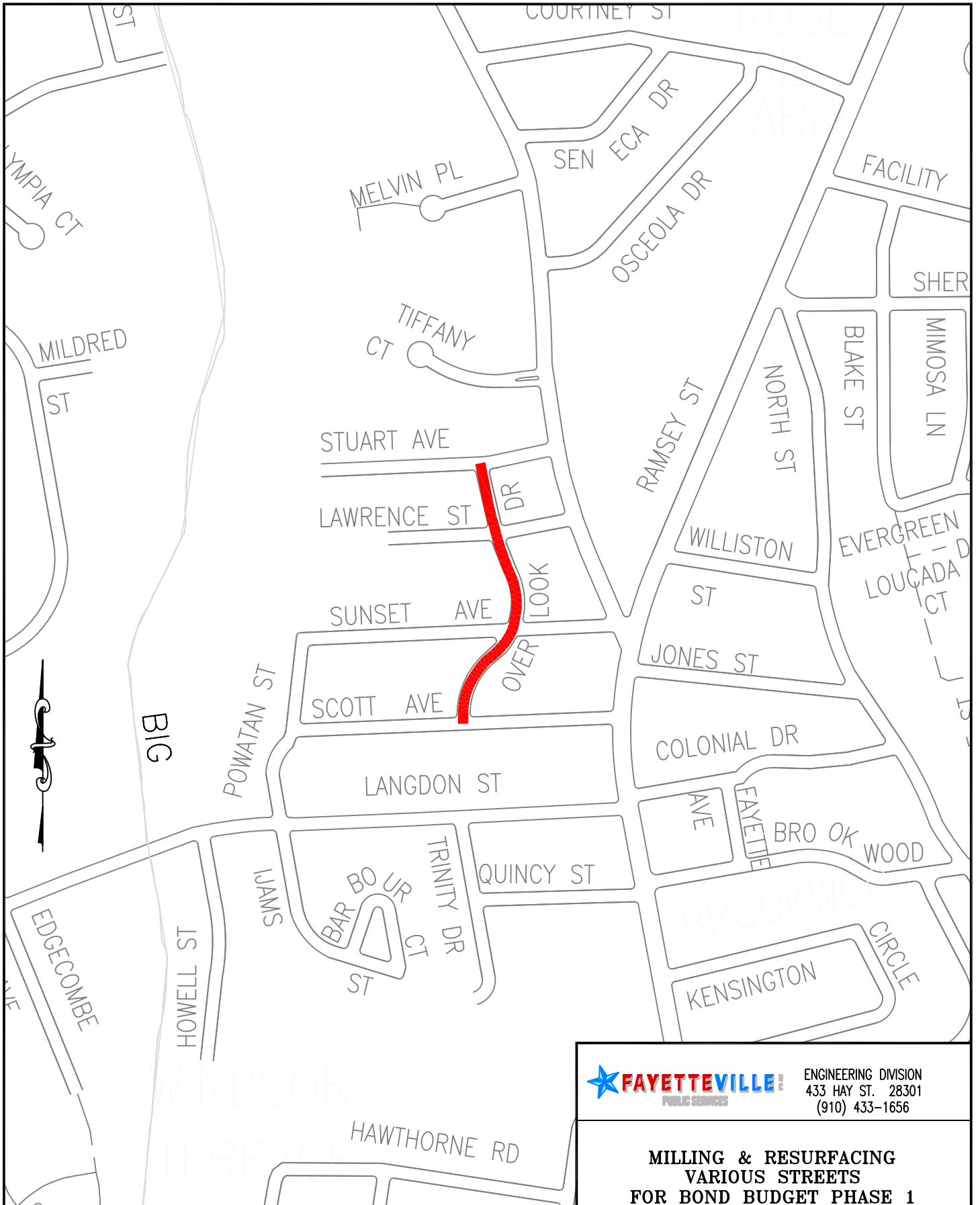

ENGINEERING DIVISION  
 433 HAY ST. 28301  
 (910) 433-1656

**MILLING & RESURFACING  
 VARIOUS STREETS  
 FOR BOND BUDGET PHASE 1**

DATE 2/23/2023 DRAWN BY RSH  
 SCALE 1" = 500' CK'D BY RSH

OVERLOOK DRIVE

**THIS MAP IS NOT A CERTIFIED SURVEY AND  
 HAS NOT BEEN REVIEWED BY A LOCAL  
 GOVERNMENT AGENCY FOR COMPLIANCE  
 WITH ANY APPLICABLE LAND DEVELOPMENT  
 REGULATIONS.**

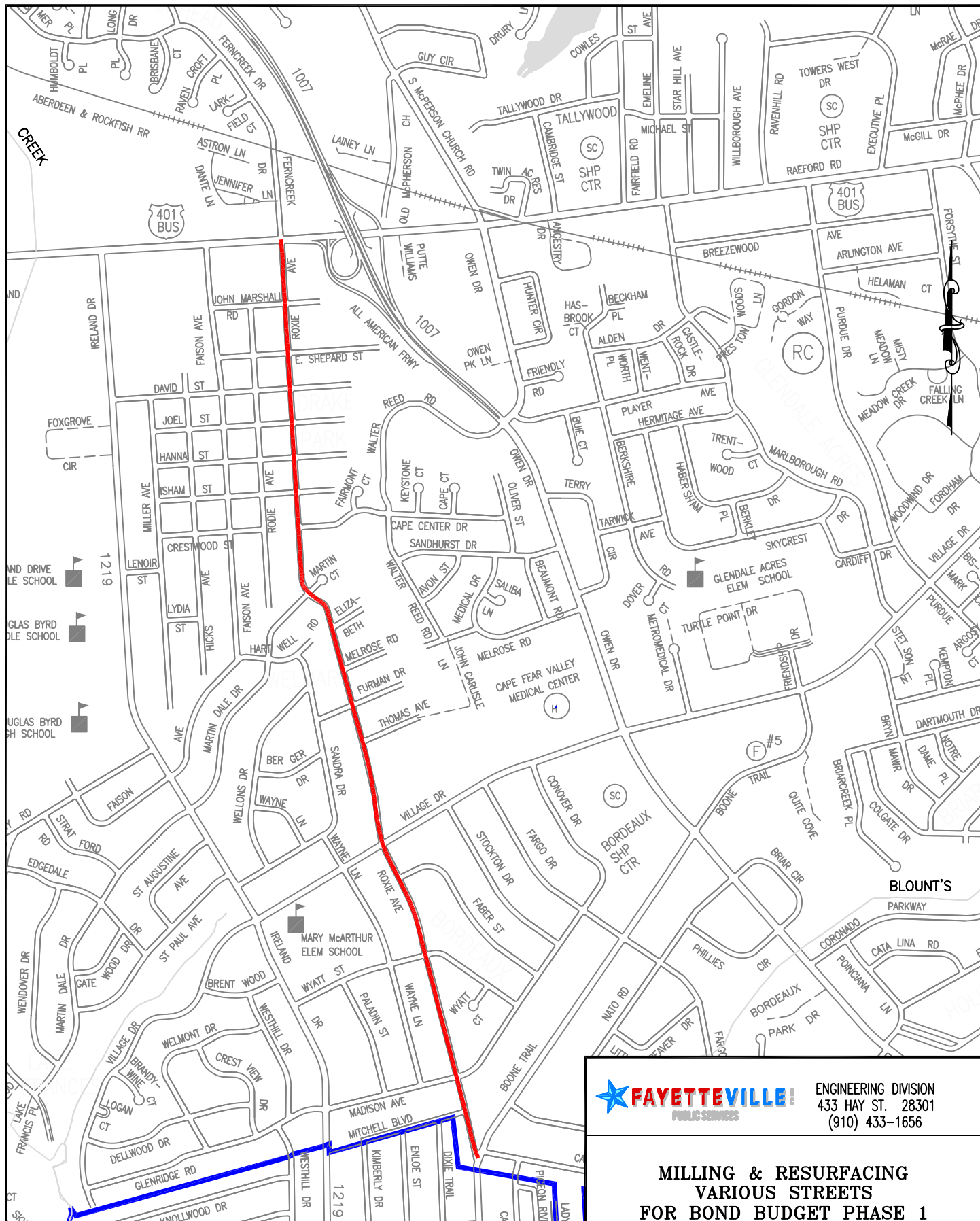

ENGINEERING DIVISION  
 433 HAY ST. 28301  
 (910) 433-1656

**MILLING & RESURFACING  
 VARIOUS STREETS  
 FOR BOND BUDGET PHASE 1**

ROXIE AVENUE

**THIS MAP IS NOT A CERTIFIED SURVEY AND  
 HAS NOT BEEN REVIEWED BY A LOCAL  
 GOVERNMENT AGENCY FOR COMPLIANCE  
 WITH ANY APPLICABLE LAND DEVELOPMENT  
 REGULATIONS.**

DATE 2/23/2023

DRAWN BY RSH

SCALE N.T.S.

CK'D BY RSH

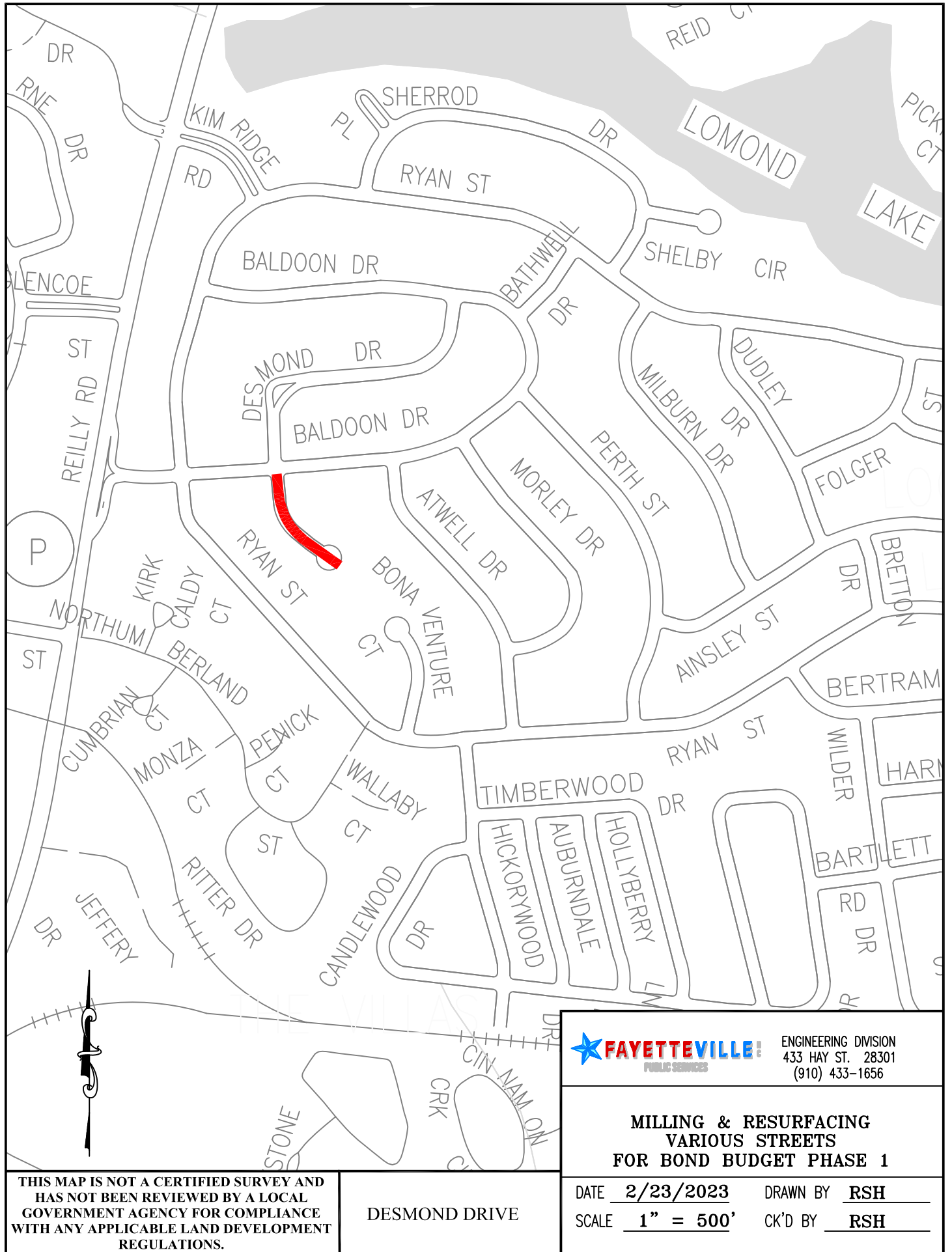

ENGINEERING DIVISION  
 433 HAY ST. 28301  
 (910) 433-1656

**MILLING & RESURFACING  
 VARIOUS STREETS  
 FOR BOND BUDGET PHASE 1**

DATE 2/23/2023 DRAWN BY RSH  
 SCALE 1" = 500' CK'D BY RSH

THIS MAP IS NOT A CERTIFIED SURVEY AND HAS NOT BEEN REVIEWED BY A LOCAL GOVERNMENT AGENCY FOR COMPLIANCE WITH ANY APPLICABLE LAND DEVELOPMENT REGULATIONS.

DESMOND DRIVE



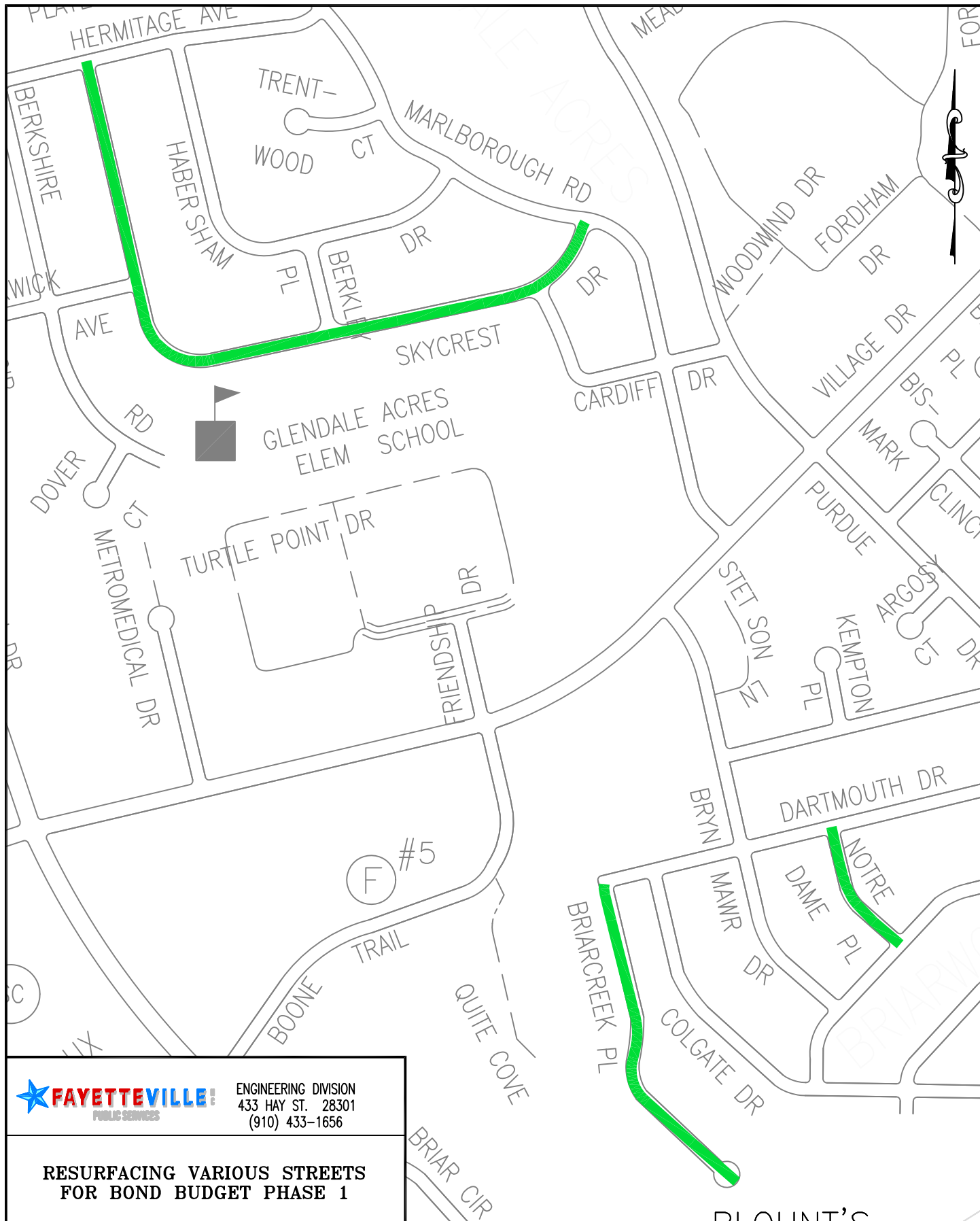

ENGINEERING DIVISION  
433 HAY ST. 28301  
(910) 433-1656

**RESURFACING VARIOUS STREETS  
FOR BOND BUDGET PHASE 1**

DATE 2/23/2023

DRAWN BY RSH

SCALE 1" = 500'

CK'D BY RSH

**THIS MAP IS NOT A CERTIFIED SURVEY AND  
HAS NOT BEEN REVIEWED BY A LOCAL  
GOVERNMENT AGENCY FOR COMPLIANCE  
WITH ANY APPLICABLE LAND DEVELOPMENT  
REGULATIONS.**

**SKYCREST DRIVE  
NOTRE DAME PLACE  
BRIARCREEK PLACE**

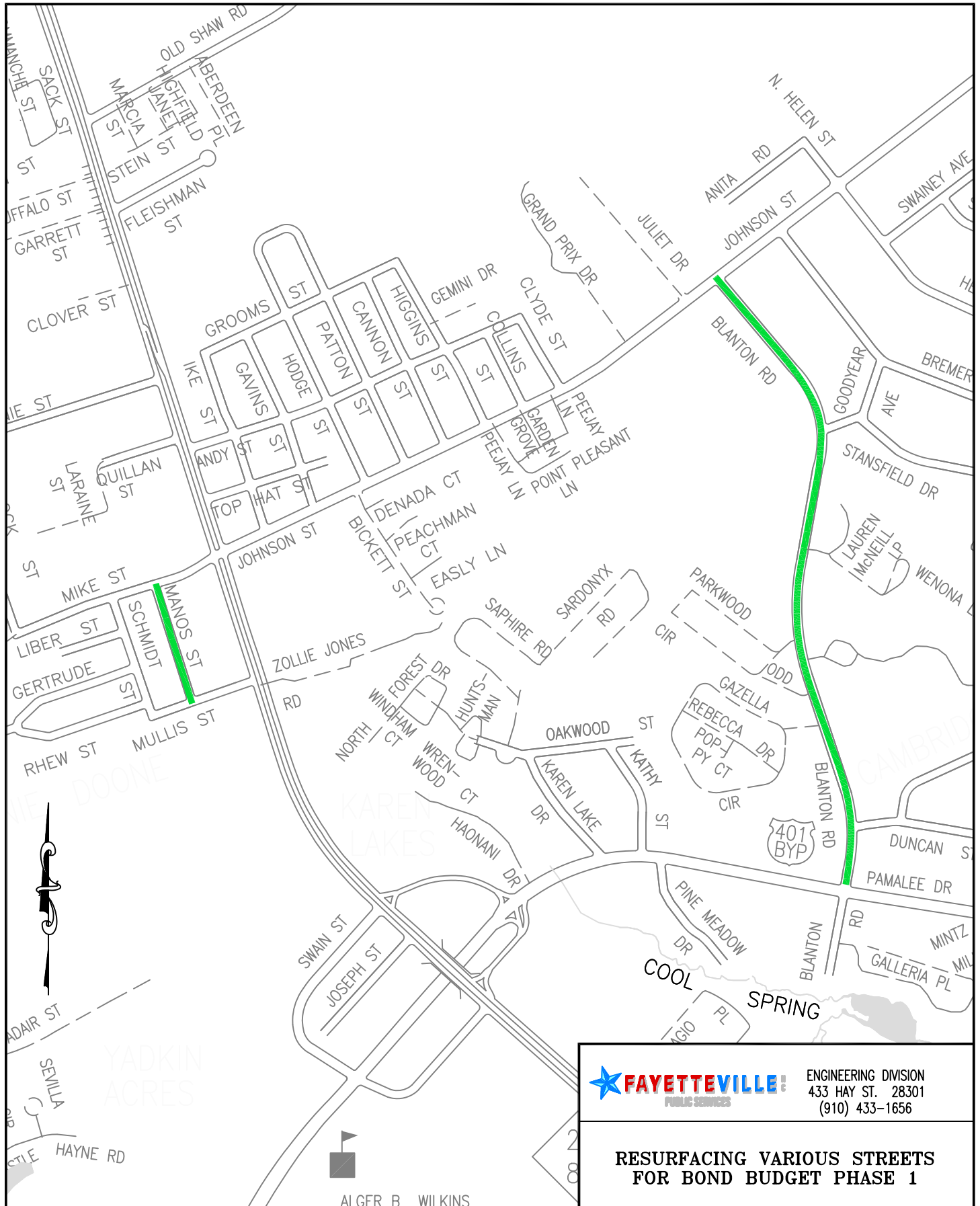

ENGINEERING DIVISION  
 433 HAY ST. 28301  
 (910) 433-1656

**RESURFACING VARIOUS STREETS  
 FOR BOND BUDGET PHASE 1**

DATE 2/23/2023 DRAWN BY RSH  
 SCALE N.T.S. CK'D BY RSH

**THIS MAP IS NOT A CERTIFIED SURVEY AND  
 HAS NOT BEEN REVIEWED BY A LOCAL  
 GOVERNMENT AGENCY FOR COMPLIANCE  
 WITH ANY APPLICABLE LAND DEVELOPMENT  
 REGULATIONS.**

**MANOS STREET  
 BLANTON ROAD**

ALGER B. WILKINS

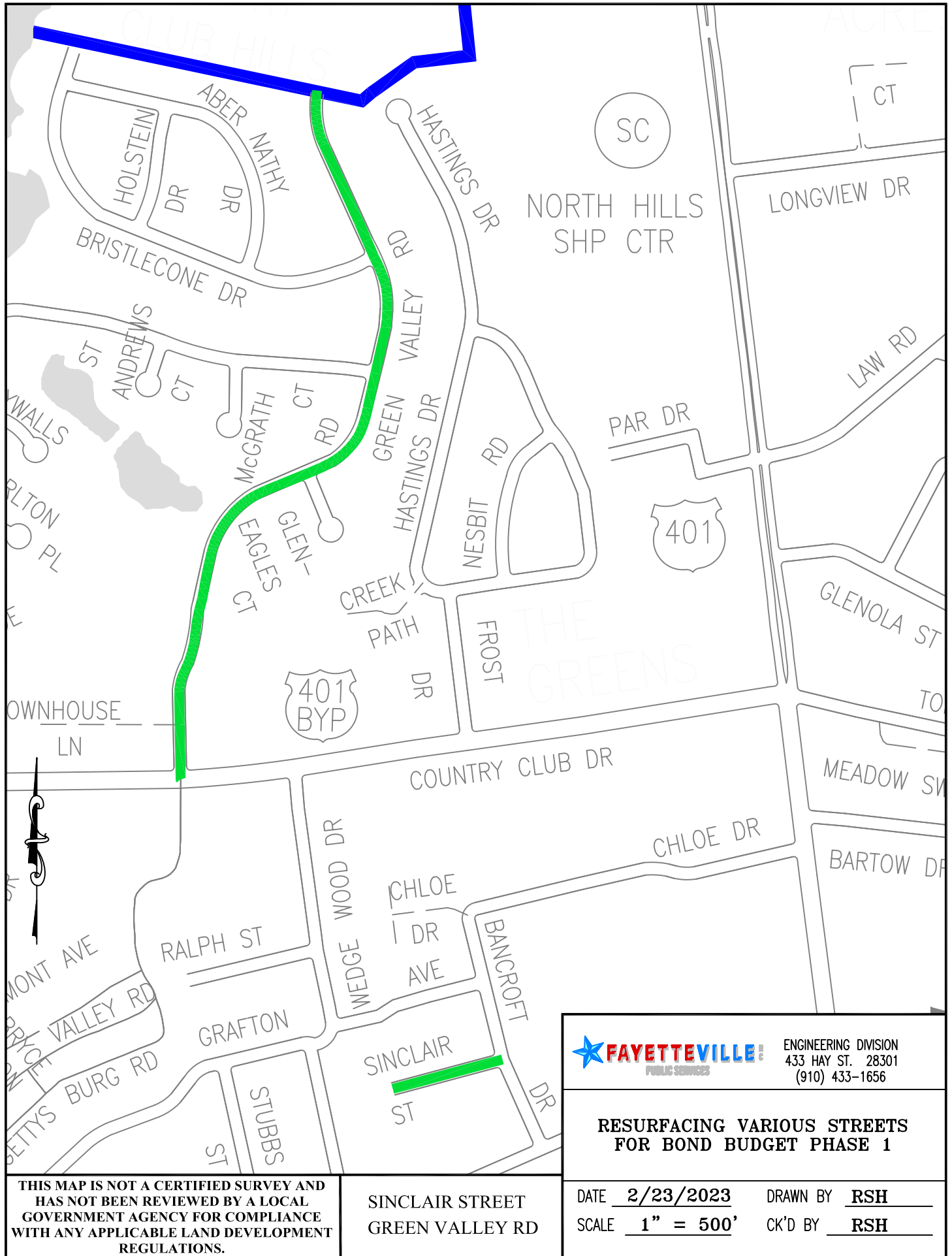

THIS MAP IS NOT A CERTIFIED SURVEY AND HAS NOT BEEN REVIEWED BY A LOCAL GOVERNMENT AGENCY FOR COMPLIANCE WITH ANY APPLICABLE LAND DEVELOPMENT REGULATIONS.

SINCLAIR STREET  
GREEN VALLEY RD

**FAYETTEVILLE** ENGINEERING DIVISION  
PUBLIC SERVICES 433 HAY ST. 28301  
(910) 433-1656

**RESURFACING VARIOUS STREETS FOR BOND BUDGET PHASE 1**

DATE 2/23/2023 DRAWN BY RSH  
SCALE 1" = 500' CK'D BY RSH



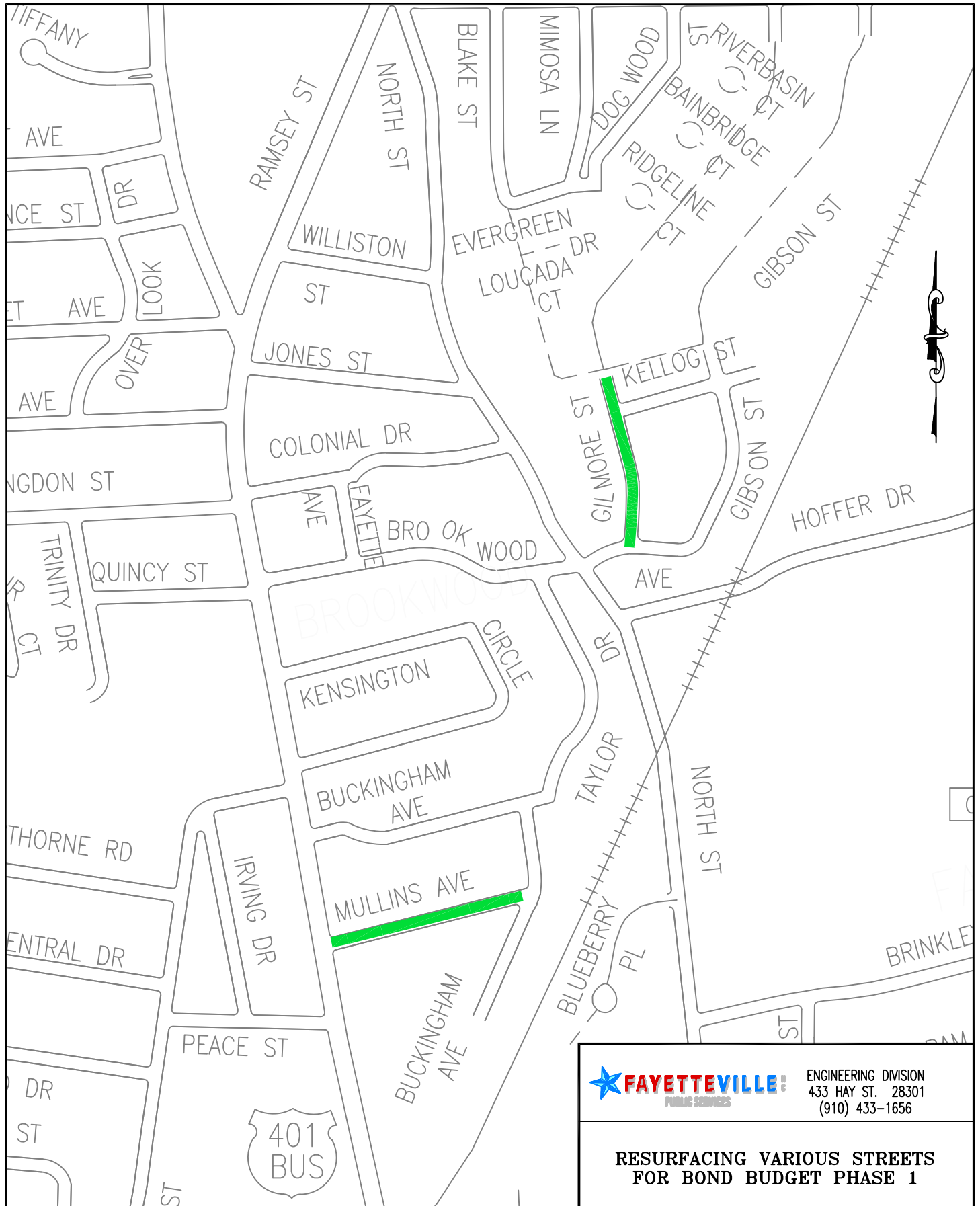



**FAYETTEVILLE** ENGINEERING DIVISION  
 PUBLIC SERVICES 433 HAY ST. 28301  
 (910) 433-1656

**RESURFACING VARIOUS STREETS FOR BOND BUDGET PHASE 1**

MULLINS AVENUE  
GILMORE STREET

THIS MAP IS NOT A CERTIFIED SURVEY AND HAS NOT BEEN REVIEWED BY A LOCAL GOVERNMENT AGENCY FOR COMPLIANCE WITH ANY APPLICABLE LAND DEVELOPMENT REGULATIONS.

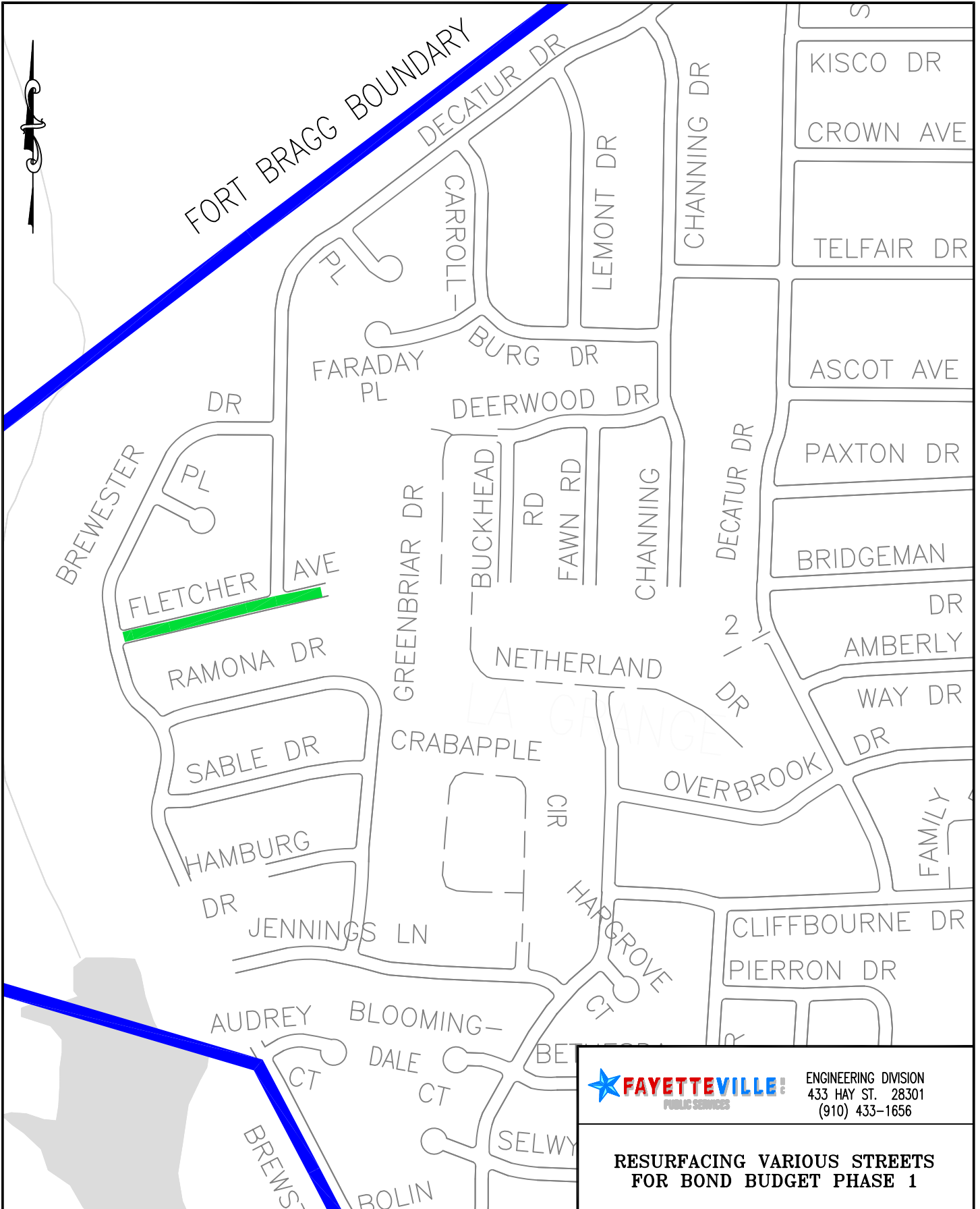
DATE 2/23/2023 DRAWN BY RSB  
 SCALE 1" = 500' CK'D BY RSB



THIS MAP IS NOT A CERTIFIED SURVEY AND HAS NOT BEEN REVIEWED BY A LOCAL GOVERNMENT AGENCY FOR COMPLIANCE WITH ANY APPLICABLE LAND DEVELOPMENT REGULATIONS.

FLETCHER DRIVE

 **FAYETTEVILLE!** ENGINEERING DIVISION  
 PUBLIC SERVICES 433 HAY ST. 28301  
 (910) 433-1656

**RESURFACING VARIOUS STREETS FOR BOND BUDGET PHASE 1**

DATE 2/23/2023 DRAWN BY RSH  
 SCALE 1" = 500' CK'D BY RSH

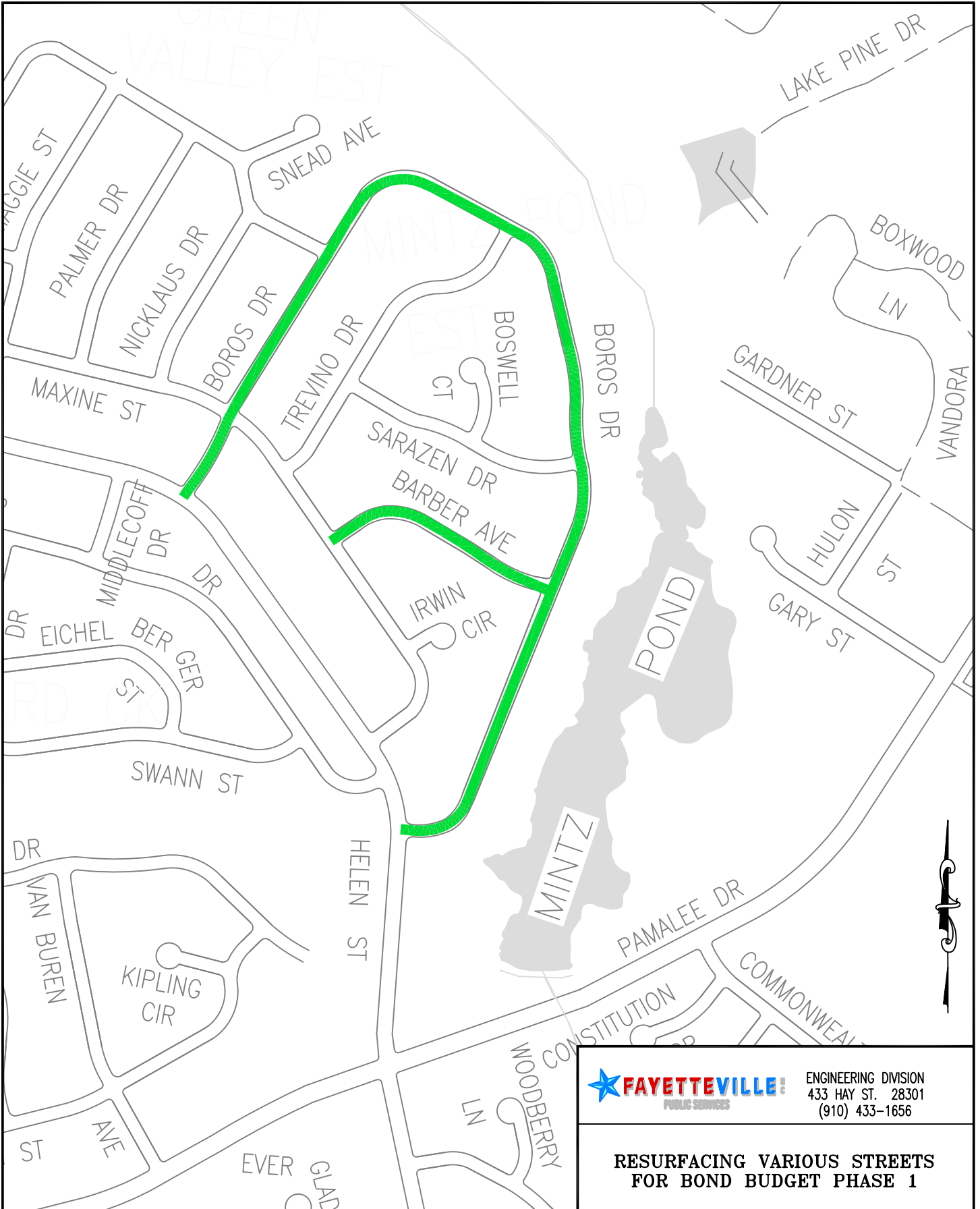

**FAYETTEVILLE** ENGINEERING DIVISION  
PUBLIC SERVICES 433 HAY ST. 28301  
 (910) 433-1656

**RESURFACING VARIOUS STREETS  
 FOR BOND BUDGET PHASE 1**

THIS MAP IS NOT A CERTIFIED SURVEY AND HAS NOT BEEN REVIEWED BY A LOCAL GOVERNMENT AGENCY FOR COMPLIANCE WITH ANY APPLICABLE LAND DEVELOPMENT REGULATIONS.

BOROS DRIVE  
 BARBER AVENUE

DATE 2/23/2023 DRAWN BY RSH  
 SCALE 1" = 500' CK'D BY RSH

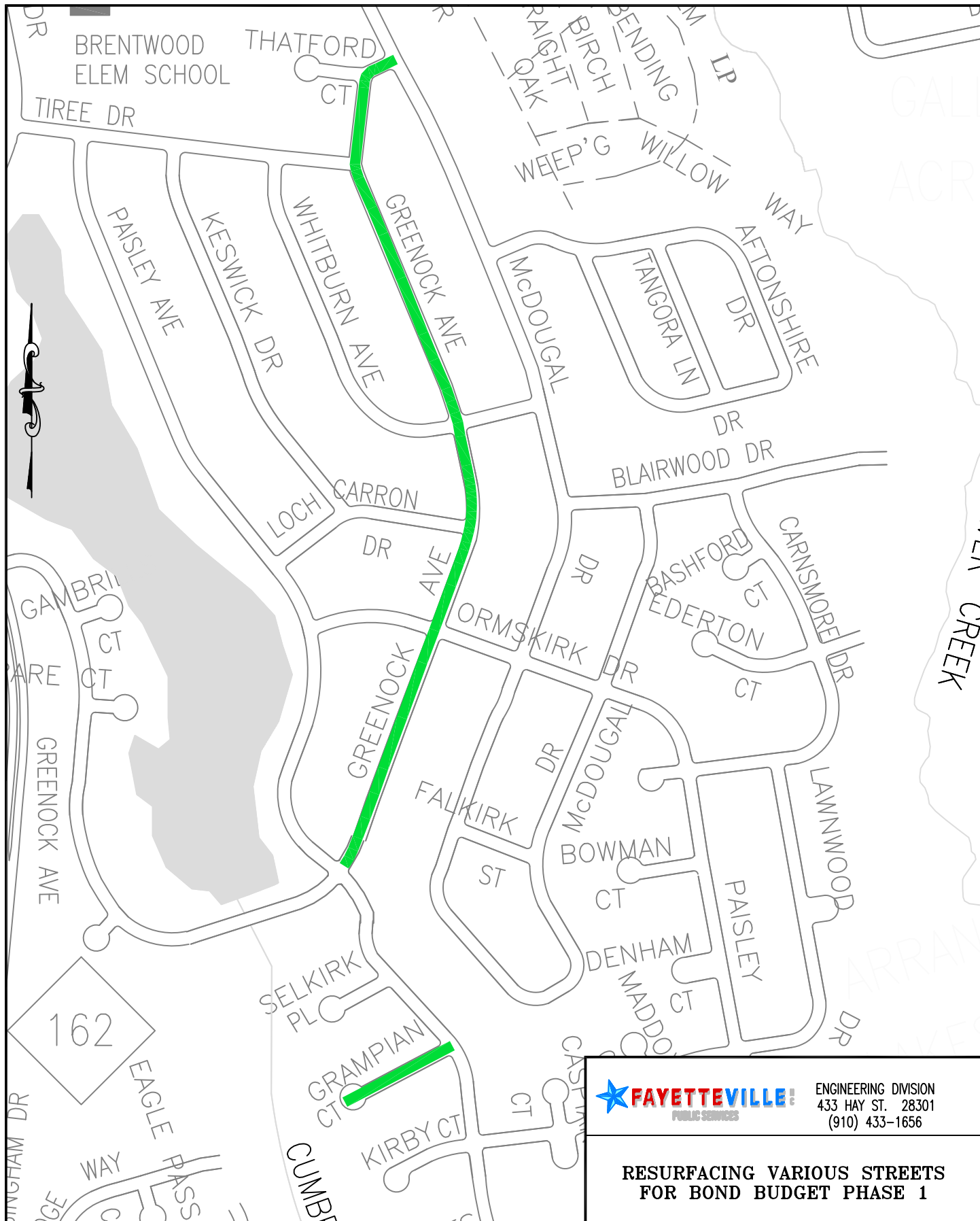

ENGINEERING DIVISION  
 433 HAY ST. 28301  
 (910) 433-1656

**RESURFACING VARIOUS STREETS  
 FOR BOND BUDGET PHASE 1**

THIS MAP IS NOT A CERTIFIED SURVEY AND HAS NOT BEEN REVIEWED BY A LOCAL GOVERNMENT AGENCY FOR COMPLIANCE WITH ANY APPLICABLE LAND DEVELOPMENT REGULATIONS.

GRAMPIAN COURT  
 GREENOCK AVENUE

DATE 2/23/2023 DRAWN BY RSH  
 SCALE 1" = 500' CK'D BY RSH

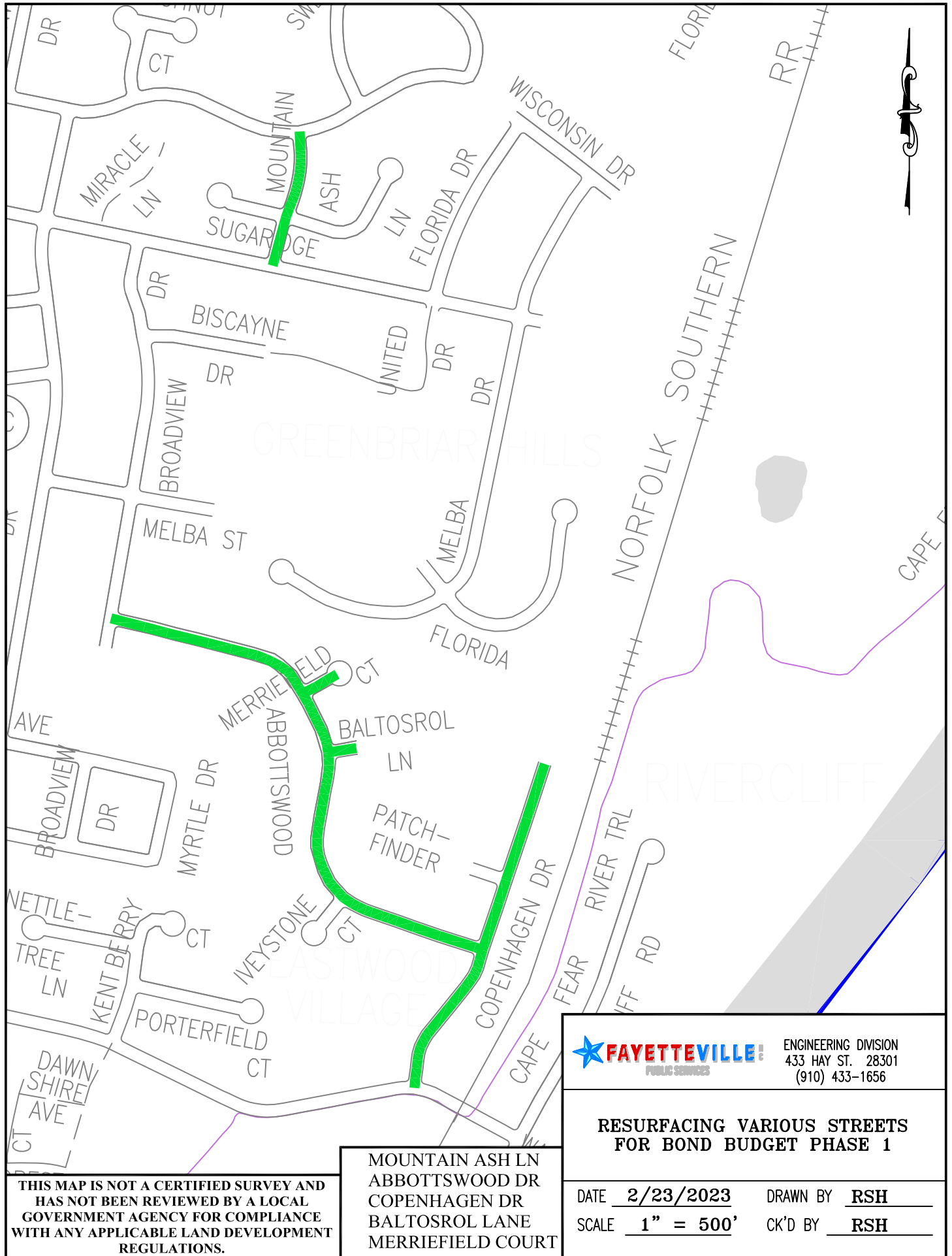

THIS MAP IS NOT A CERTIFIED SURVEY AND HAS NOT BEEN REVIEWED BY A LOCAL GOVERNMENT AGENCY FOR COMPLIANCE WITH ANY APPLICABLE LAND DEVELOPMENT REGULATIONS.

MOUNTAIN ASH LN  
 ABBOTTSWOOD DR  
 COPENHAGEN DR  
 BALTOSROL LANE  
 MERRIFIELD COURT

**FAYETTEVILLE** PUBLIC SERVICES ENGINEERING DIVISION  
 433 HAY ST. 28301  
 (910) 433-1656

**RESURFACING VARIOUS STREETS FOR BOND BUDGET PHASE 1**

DATE 2/23/2023 DRAWN BY RSH  
 SCALE 1" = 500' CK'D BY RSH



THIS MAP IS NOT A CERTIFIED SURVEY AND HAS NOT BEEN REVIEWED BY A LOCAL GOVERNMENT AGENCY FOR COMPLIANCE WITH ANY APPLICABLE LAND DEVELOPMENT REGULATIONS.

MONTROSE DRIVE  
 BARFIELD DRIVE  
 URIAH DRIVE  
 RIVENDALE DRIVE

**FAYETTEVILLE** ENGINEERING DIVISION  
PUBLIC SERVICES 433 HAY ST. 28301  
 (910) 433-1656

**RESURFACING VARIOUS STREETS FOR BOND BUDGET PHASE 1**

DATE 2/23/2023 DRAWN BY RSH  
 SCALE 1" = 500' CK'D BY RSH



ENGINEERING DIVISION  
 433 HAY ST. 28301  
 (910) 433-1656

**RESURFACING VARIOUS STREETS  
 FOR BOND BUDGET PHASE 1**

EDENWOOD  
 DRIVE

**THIS MAP IS NOT A CERTIFIED SURVEY AND  
 HAS NOT BEEN REVIEWED BY A LOCAL  
 GOVERNMENT AGENCY FOR COMPLIANCE  
 WITH ANY APPLICABLE LAND DEVELOPMENT  
 REGULATIONS.**

DATE 2/23/2023 DRAWN BY RSH  
 SCALE 1" = 500' CK'D BY RSH

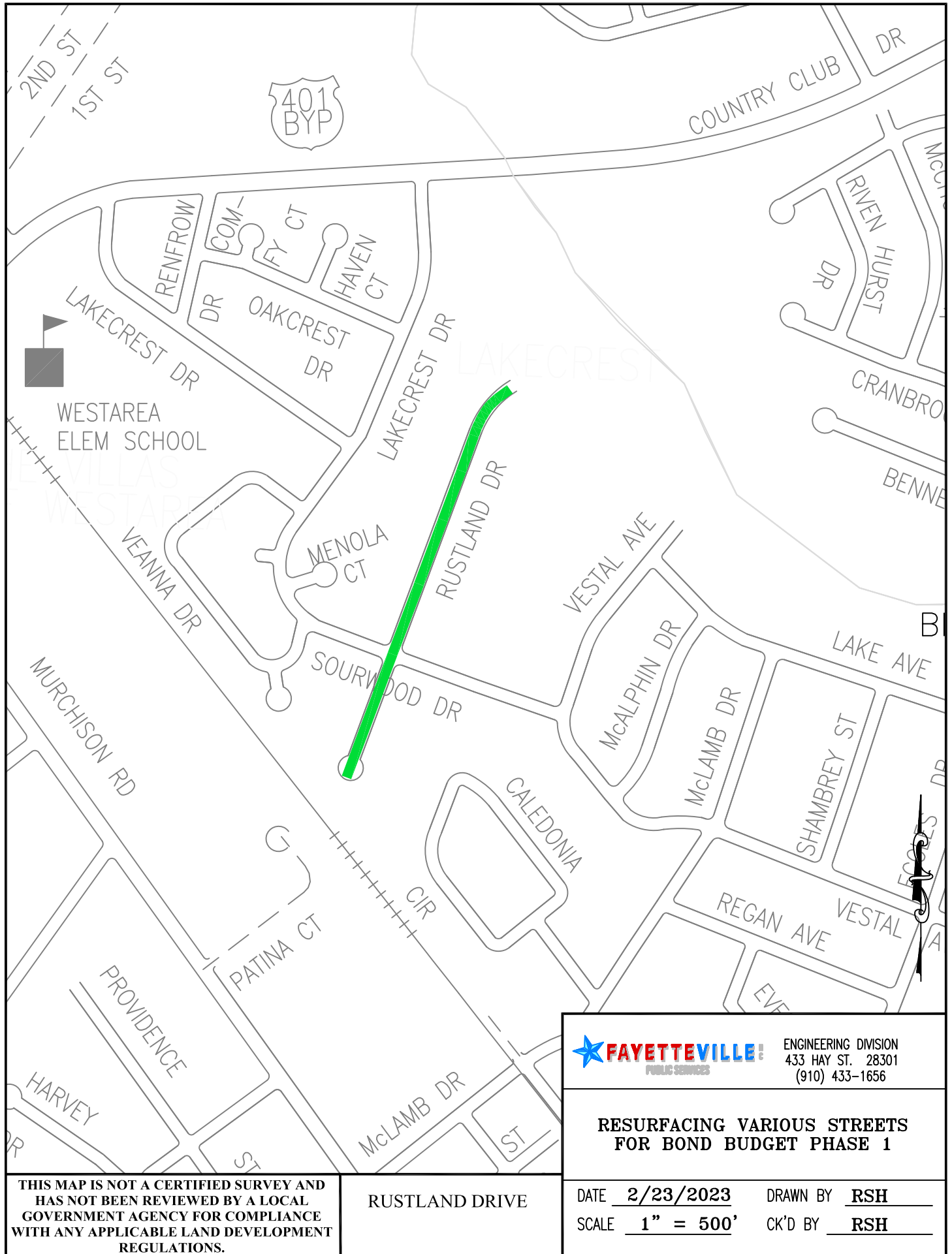

THIS MAP IS NOT A CERTIFIED SURVEY AND HAS NOT BEEN REVIEWED BY A LOCAL GOVERNMENT AGENCY FOR COMPLIANCE WITH ANY APPLICABLE LAND DEVELOPMENT REGULATIONS.

RUSTLAND DRIVE

**FAYETTEVILLE** ENGINEERING DIVISION  
PUBLIC SERVICES 433 HAY ST. 28301  
 (910) 433-1656

**RESURFACING VARIOUS STREETS FOR BOND BUDGET PHASE 1**

DATE 2/23/2023 DRAWN BY RSH  
 SCALE 1" = 500' CK'D BY RSH



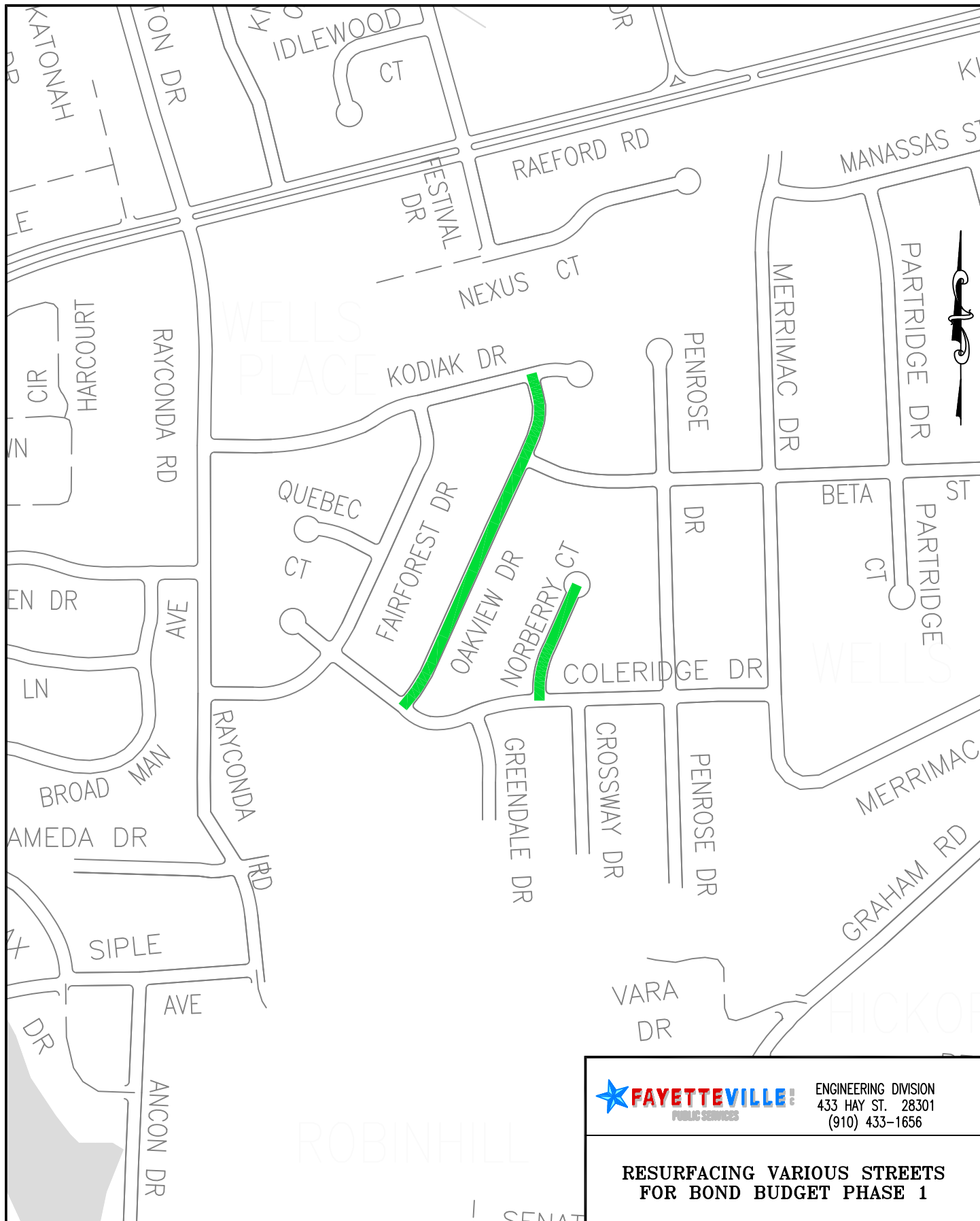

ENGINEERING DIVISION  
 433 HAY ST. 28301  
 (910) 433-1656

**RESURFACING VARIOUS STREETS  
 FOR BOND BUDGET PHASE 1**

THIS MAP IS NOT A CERTIFIED SURVEY AND HAS NOT BEEN REVIEWED BY A LOCAL GOVERNMENT AGENCY FOR COMPLIANCE WITH ANY APPLICABLE LAND DEVELOPMENT REGULATIONS.

OAKVIEW DRIVE  
 NORBERRY COURT

DATE 2/23/2023 DRAWN BY RSH  
 SCALE 1" = 500' CK'D BY RSH

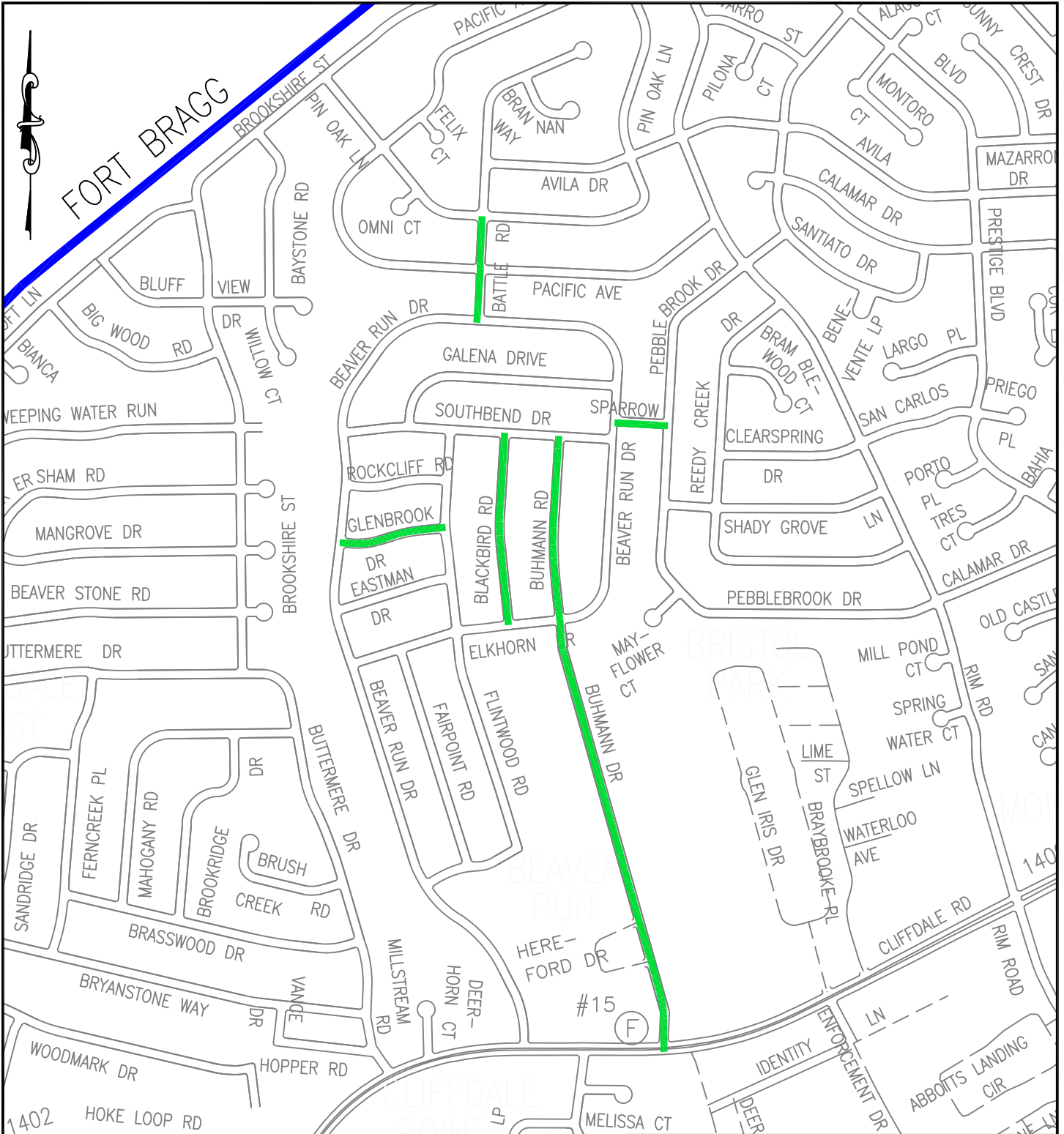

THIS MAP IS NOT A CERTIFIED SURVEY AND HAS NOT BEEN REVIEWED BY A LOCAL GOVERNMENT AGENCY FOR COMPLIANCE WITH ANY APPLICABLE LAND DEVELOPMENT REGULATIONS.

GLENBROOK DRIVE  
 BLACKBIRD ROAD  
 BUHMANN DRIVE  
 SPARROW DRIVE  
 BATTLE ROAD

 **FAYETTEVILLE**  
 PUBLIC SERVICES

ENGINEERING DIVISION  
 433 HAY ST. 28301  
 (910) 433-1656

**RESURFACING VARIOUS STREETS  
 FOR BOND BUDGET PHASE 1**

DATE 2/23/2023 DRAWN BY RSH  
 SCALE N.T.S. CK'D BY RSH

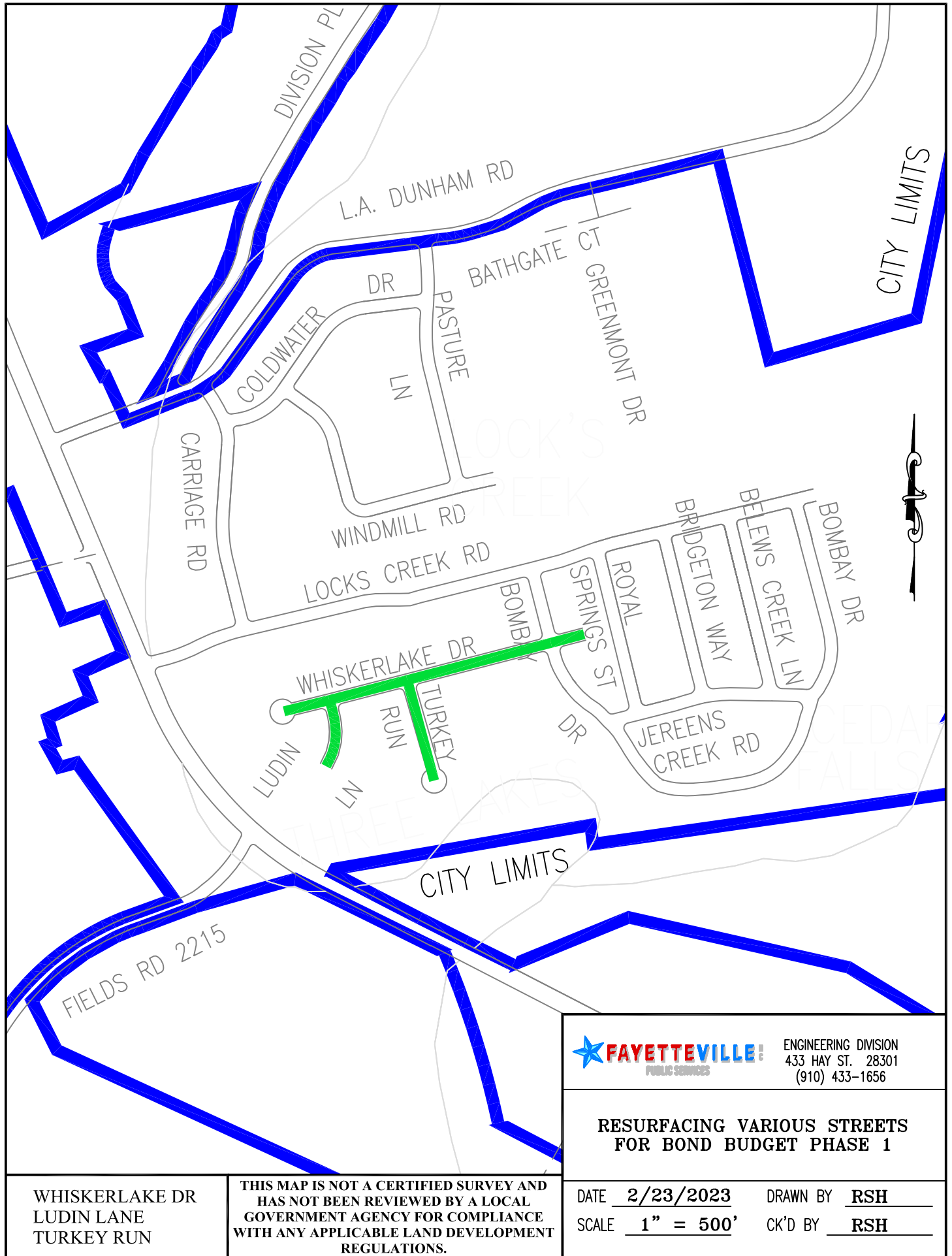

ENGINEERING DIVISION  
 433 HAY ST. 28301  
 (910) 433-1656

**RESURFACING VARIOUS STREETS  
 FOR BOND BUDGET PHASE 1**

WHISKERLAKE DR  
 LUDIN LANE  
 TURKEY RUN

**THIS MAP IS NOT A CERTIFIED SURVEY AND  
 HAS NOT BEEN REVIEWED BY A LOCAL  
 GOVERNMENT AGENCY FOR COMPLIANCE  
 WITH ANY APPLICABLE LAND DEVELOPMENT  
 REGULATIONS.**

DATE 2/23/2023  
 SCALE 1" = 500'

DRAWN BY RSH  
 CK'D BY RSH



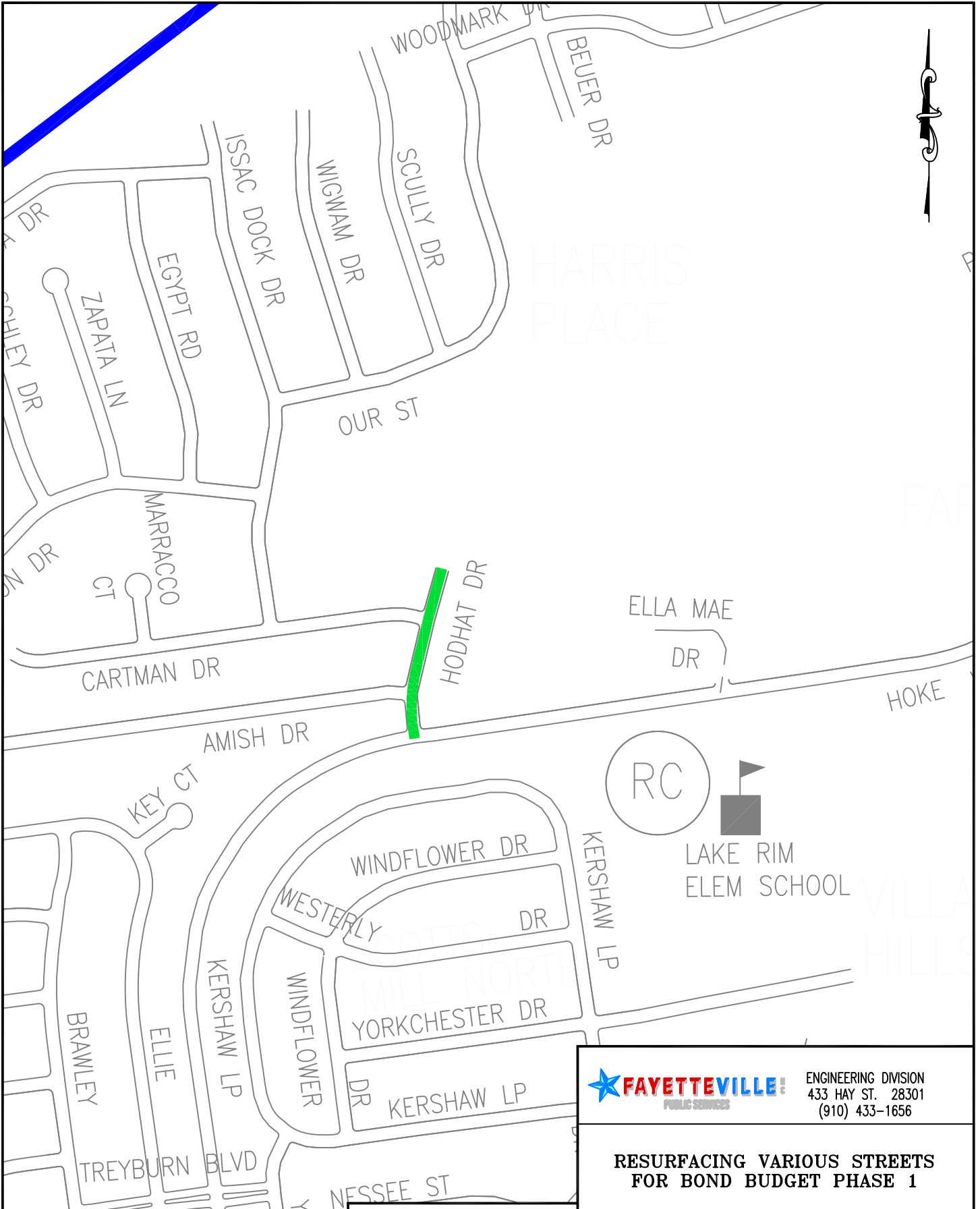

THIS MAP IS NOT A CERTIFIED SURVEY AND HAS NOT BEEN REVIEWED BY A LOCAL GOVERNMENT AGENCY FOR COMPLIANCE WITH ANY APPLICABLE LAND DEVELOPMENT REGULATIONS.

HODHAT DRIVE

**FAYETTEVILLE** ENGINEERING DIVISION  
PUBLIC SERVICES 433 HAY ST. 28301  
 (910) 433-1656

**RESURFACING VARIOUS STREETS FOR BOND BUDGET PHASE 1**

DATE 2/23/2023 DRAWN BY RSH  
 SCALE 1" = 500' CK'D BY RSH

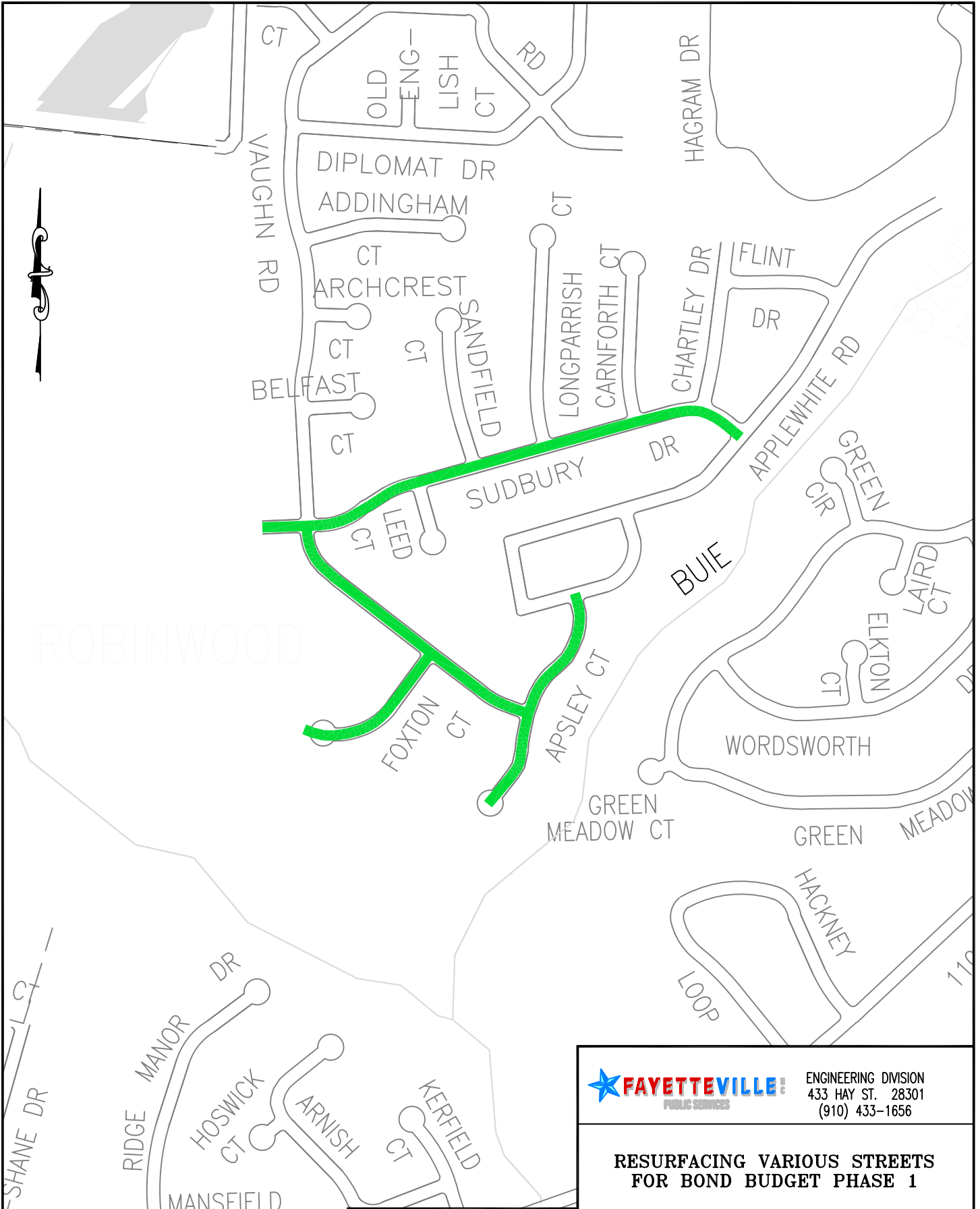

ENGINEERING DIVISION  
433 HAY ST. 28301  
(910) 433-1656

**RESURFACING VARIOUS STREETS  
FOR BOND BUDGET PHASE 1**

DATE 2/23/2023 DRAWN BY RSH  
SCALE 1" = 500' CK'D BY RSH

THIS MAP IS NOT A CERTIFIED SURVEY AND HAS NOT BEEN REVIEWED BY A LOCAL GOVERNMENT AGENCY FOR COMPLIANCE WITH ANY APPLICABLE LAND DEVELOPMENT REGULATIONS.

SUDBURY DRIVE  
APSLEY COURT  
FOXTON COURT  
VAUGHN ROAD